

<b>Theme: Substitution kit 22 902 488 for foot-switch unit 20 902 148</b>	
Theme area: Electrical	Telephone: +49 (0)40/ 739 606 – 42
Version 01/2003	Date: 21.05.2003

1.

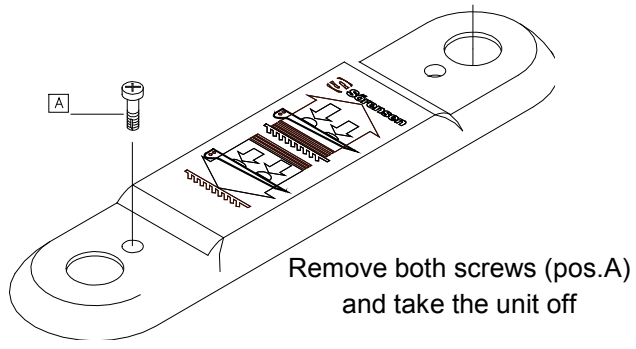

2.

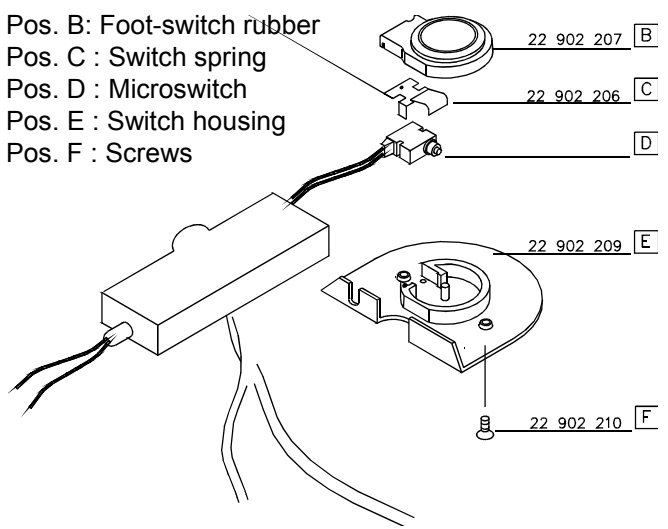
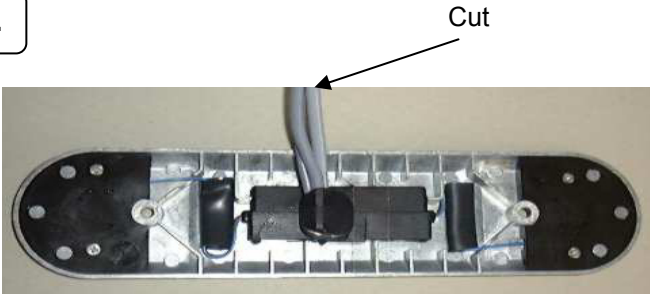

More technical information and news can be found under  
**[www.soerensen.de](http://www.soerensen.de)**

3.

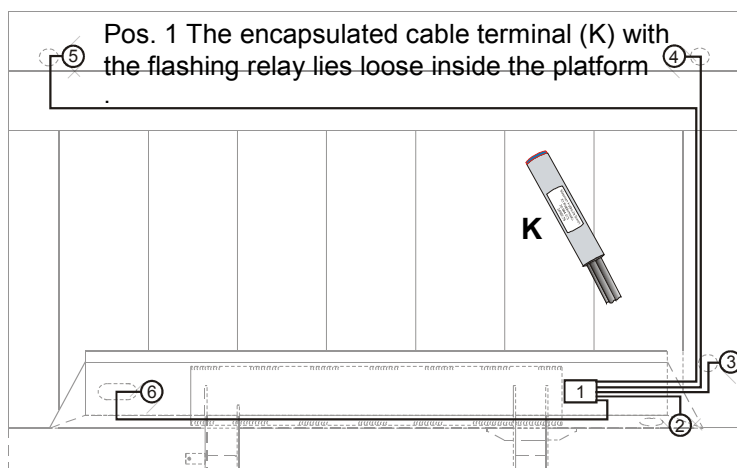

Take off the right aluminum profile. Cut the cable leading to the flashlights and the mercury switch. Take off the old cable set.

- Pos. 2 Hand-hole cover
- Pos. 3 Foot-switch unit
- Pos. 4 and 5 Flashing lights
- Pos. 6 Mercury switch

4.

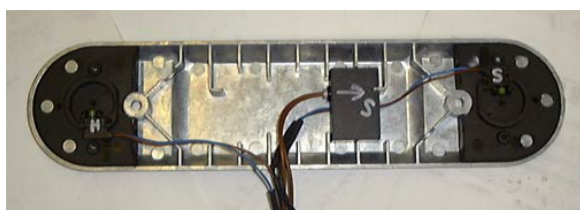
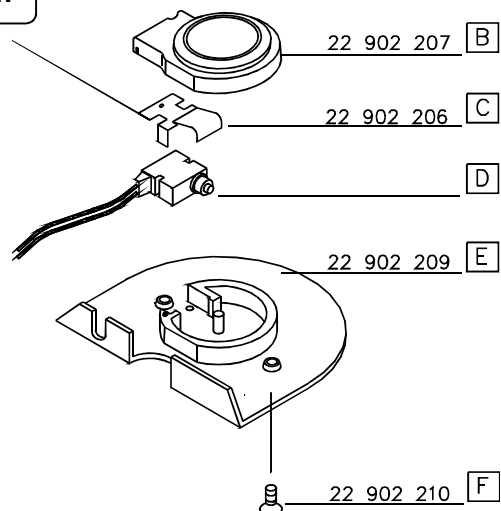

- Substitution kit 22901211
- Pos. B: Foot-switch rubber
  - Pos. C : Switch spring
  - Pos. D : Microswitch
  - Pos. E : Switch housing
  - Pos. F : Screws

More technical information and news can be found under  
[www.soerensen.de](http://www.soerensen.de)

**Assembling the kit 22 901 211 into the foot-switch housing**

The micro-switch marked S is mounted towards the vehicle.

The micro-switch marked H is mounted towards the platform tip

Position the mercury switch inside the housing

Connect the cables to the corner lights with heat shrinking connectors

1. Corner light green/yellow = minus  
1 = plus
2. Corner light                   2 = minus  
3 = plus

Connect the cables to the mercury switch with heat shrinking connectors  
Mercury switch brown and blue

Wiring diagram : 22 902 488

**In the case of a warranty, we will reimburse a maximum of 1,2 hours to retrofit the foot-switch kit 20 901 211**

More technical information and news can be found under  
**[www.soerensen.de](http://www.soerensen.de)**